

FIELD IMPROVEMENTS

OPTION A - Softball in the Bowl

ATHLETIC FIELD

LEGEND

- ATHLETIC FIELD (TURF)
- SOFTBALL INFIELD (TURF)
- TRACK SURFACING
- CINDER / INFIELD
- PAVED WALKWAYS
- PROPOSED BUILDING
- MOVEABLE DUGOUT
- SEMI-PERMANENT BACKSTOP
- TEMPORARY BACKSTOP

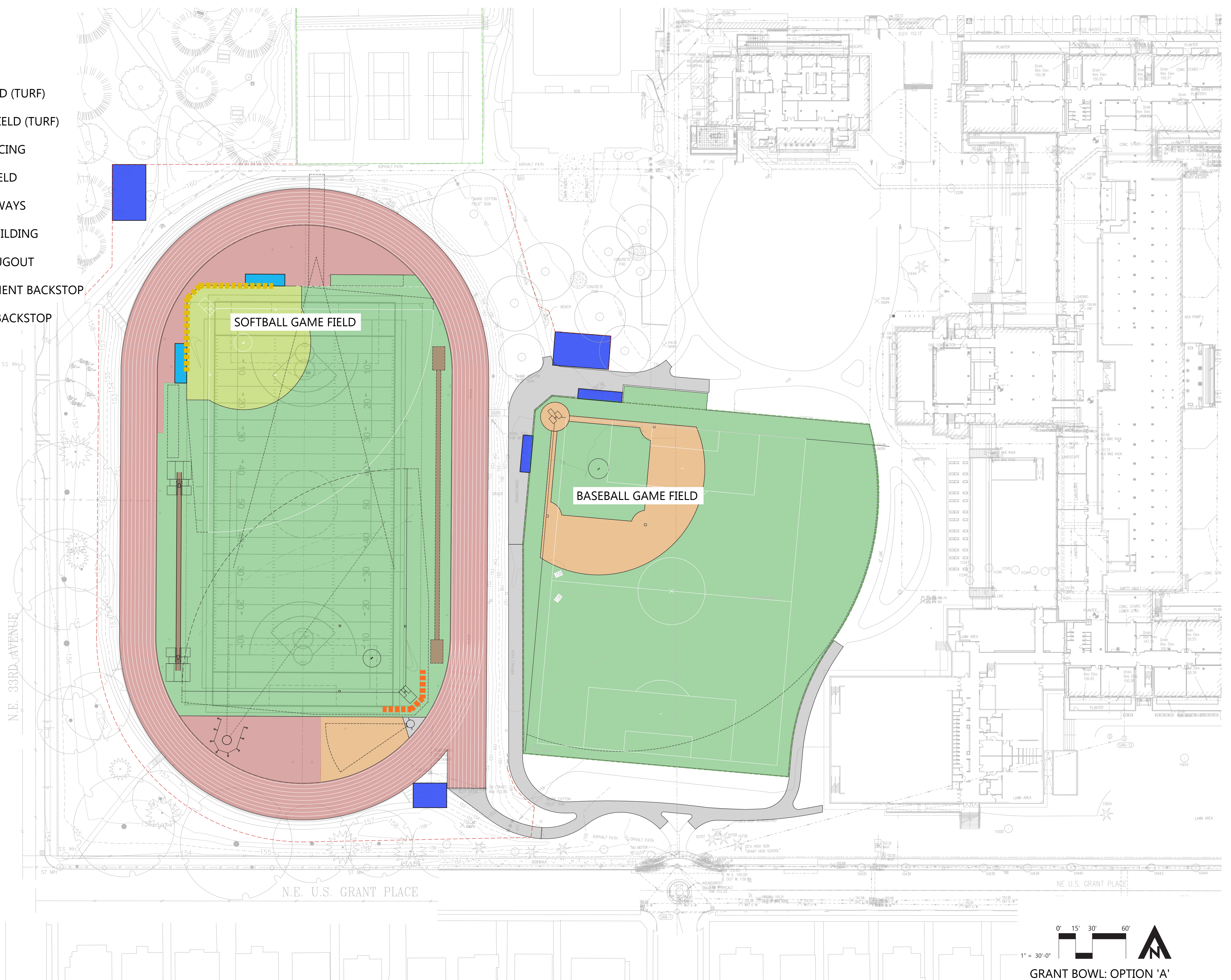

PROS

1. General: Seating and lights extend capabilities of the Bowl including hosting football and soccer games
2. Softball: Able to provide facility that complies with title IX in Grant Bowl including temporary bullpens, movable dugouts, semi-permanent backstop.
3. Softball: Sufficient backstop and fencing design for safe facility (20', Homeplate to fence)
4. Track: Increased javelin runway 68' to 95'
5. Track: Added shot put cinder landing area and more practice throwing rings.
6. Track: Added more track surfacing in 'D' Zones
7. Track: Placed discus and shot put in same 'D' Zone (coaching shared). More space for shot put practice rings.

CONS

1. Softball: Backstop fencing in Grant Bowl is 10' from football/soccer field play lines.
2. Softball: Home plate to fencing is 20' (NFHS is 25')
3. Softball: Backstop netting is semi-permanent and requires scissor lift to remove/install.
4. Softball: Outfield (200') overlap if both Bowl fields utilized.
5. Softball: Requires use of portable seating shelters for dugouts.
6. Little League: Removes both permanent backstops in Bowl
7. Soccer: Field in the Bowl reduced in width from 210' to 205' (still within regulations).
8. Track: Requires adjustment to long jump and pole vault runways









FIELD IMPROVEMENTS

OPTION B - Softball at the Upper Field

ATHLETIC FIELD

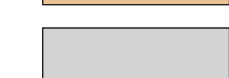
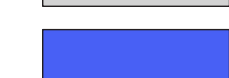
LEGEND

-  ATHLETIC FIELD (TURF)
-  SOFTBALL INFIELD (TURF)
-  TRACK SURFACING
-  CINDER / INFIELD
-  PAVED WALKWAYS
-  PROPOSED BUILDING
-  PERMANENT BACKSTOP

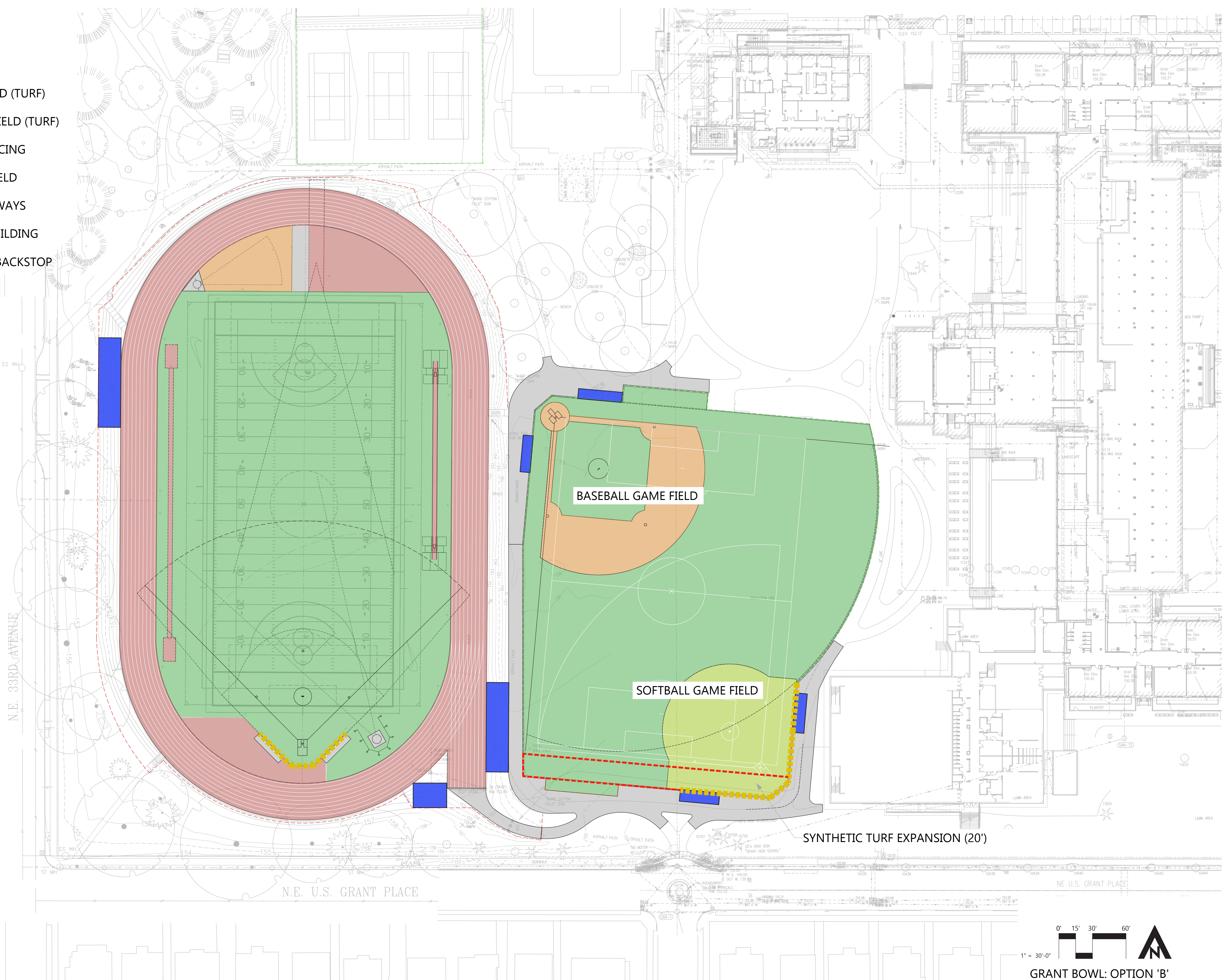

PROS

1. General: Seating and lights extend capabilities of the Bowl including hosting football and soccer games
2. General: Adds lights to upper field to extend use of facility
3. Softball: Able to provide facility that complies with title IX on upper field including bullpen and permanent covered dugouts
4. Softball: Sufficient backstop and fencing design for safe facility (25', homeplate to fence) on upper field
5. Softball: Upper field linework less distracting (no football lines)
6. Softball: More easily accessible seating for spectators
7. Softball: Closer to locker room and indoor facilities
8. Soccer: Adds length to upper field by extending turf south
9. Track: Increased javelin runway 68' to 95'
10. Track: Added shot put cinder landing area and more practice throwing rings.
11. Track: Added more surface in 'D' Zone (possible high jump)

CONS

1. General: Renovation to new field multi-use field.
2. General: Expansion of multi-use upper field reduces landscape area.
3. General: Requires additional investment for lights on upper field.
4. Little League: Removes one Grant Bowl backstop (permanent chainlink).
5. Baseball and softball: Will need to coordinate as fields overlap on upper field.

FIELD LIGHTING AND SCOREBOARD

OPTION A - Softball in the Bowl

FIELD LIGHTING

LEGEND

-  PROPOSED LIGHTING
-  PROPOSED SCOREBOARD
-  EXISTING SCOREBOARD

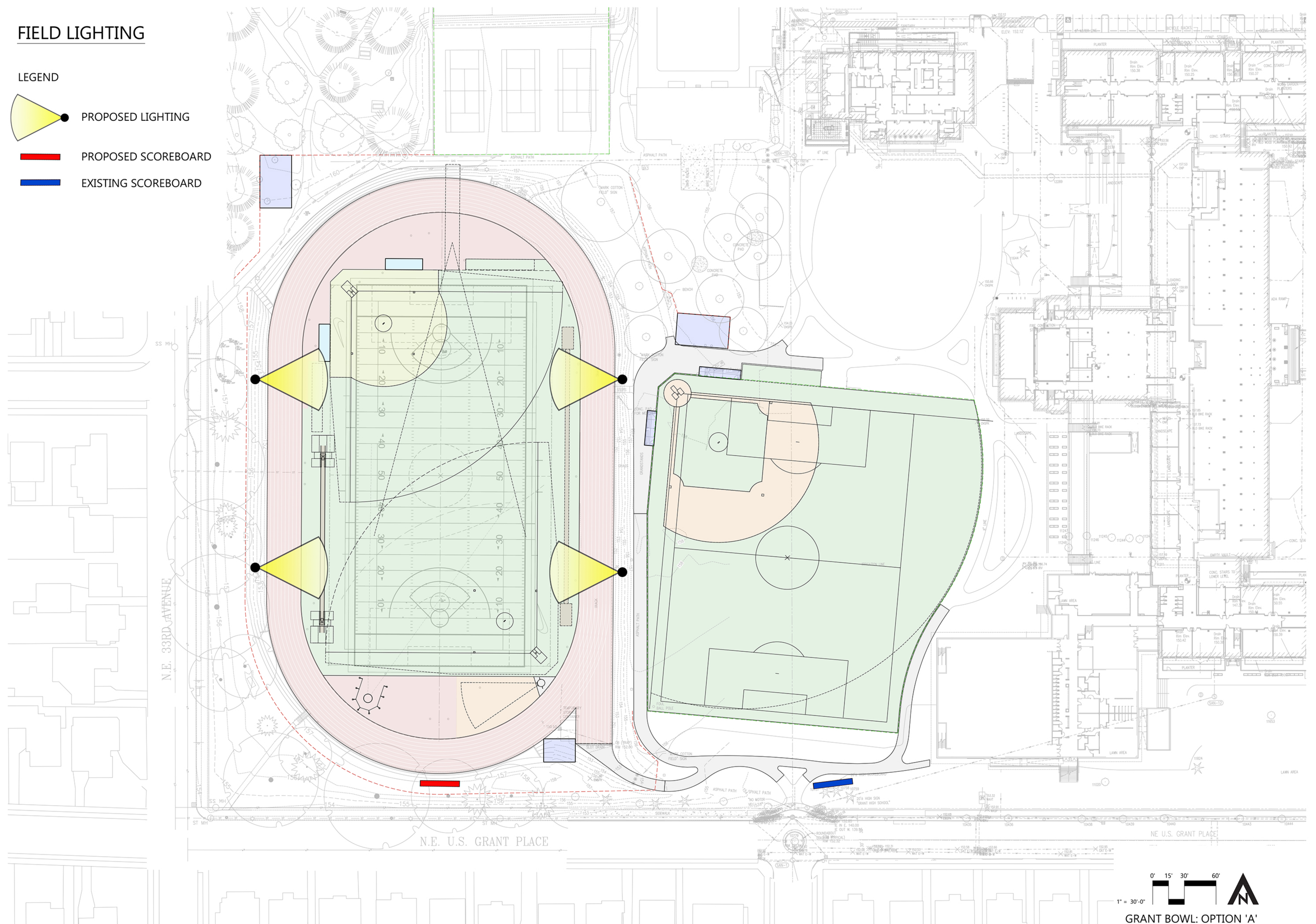

PROS

1. Increases the usability of the Bowl for a wide array of activities and events.
2. Allows home football, soccer, lacrosse games
3. Accommodates softball practice and games at GHS
4. Provides low level lighting of track for community early morning, evening use
5. Increases safety of the park by adding more activity and more lights
6. Reduces vandalism of the Bowl and the park
7. Scoreboard faces north, away from neighbors houses
8. Maintains use of existing scoreboard for baseball

CONS

1. Upper field remains without lights limiting its use



FIELD LIGHTING AND SCOREBOARD

OPTION B - Softball at the Upper Field

FIELD LIGHTING

LEGEND

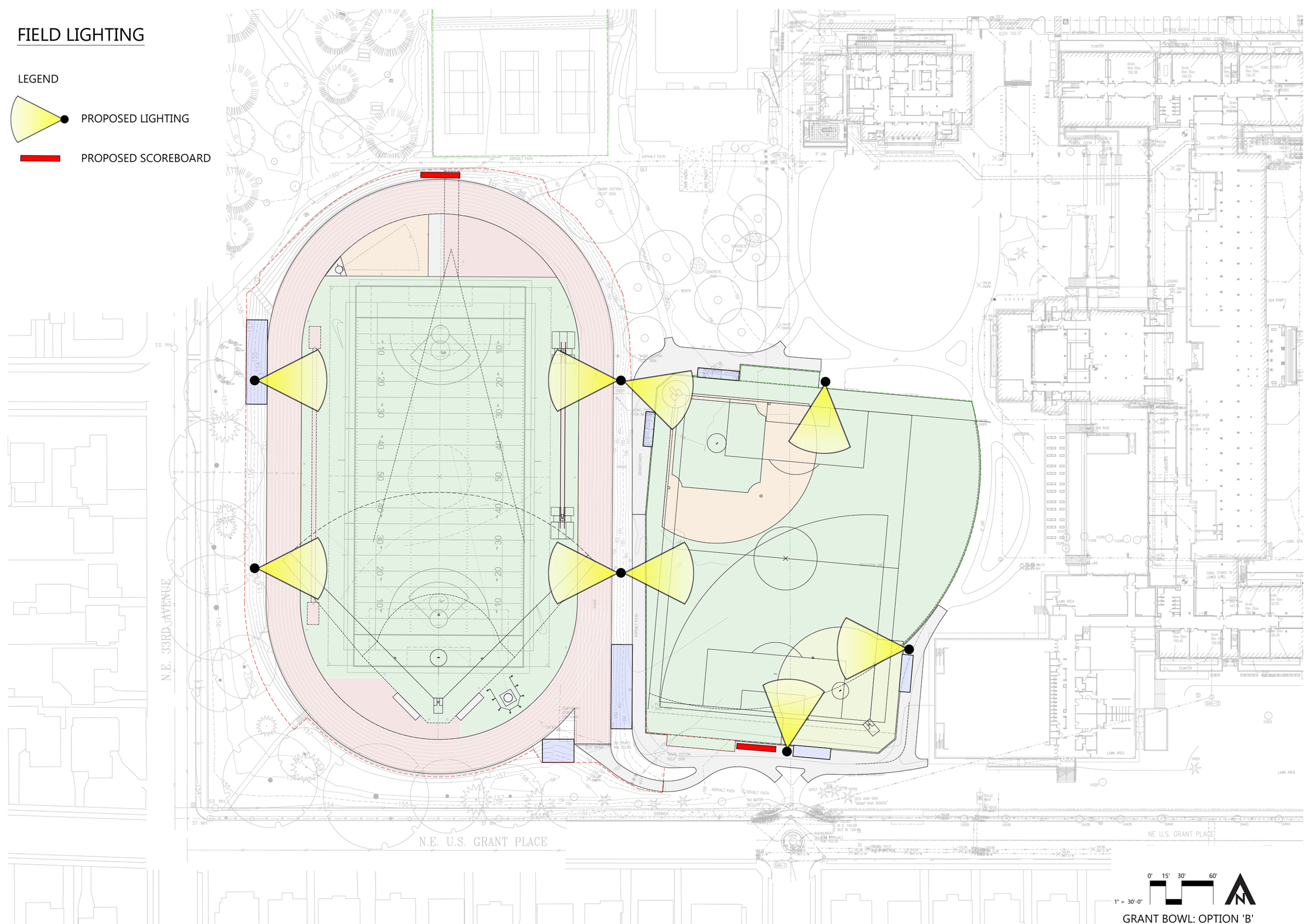
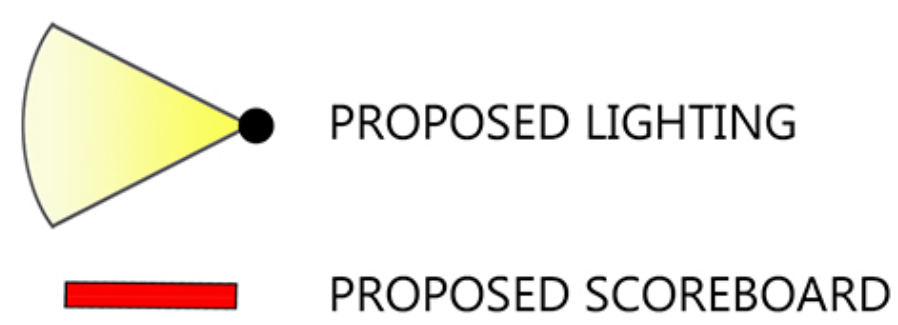

PROS

1. Increases the usability of the Bowl for a wide array of activities and events.
2. Allows home football, soccer, lacrosse games
3. Allows evening use of upper field for practice and games
4. Accommodates softball practice and games at GHS
5. Provides low level lighting of track for community early morning evening use
6. Increases safety of the park by adding more activity and more lights
7. Reduces vandalism of the Bowl and the park
8. Efficiency of using singles poles for back to back field lighting

CONS

1. Additional cost of additional lights
2. Bowl scoreboard faces south, may be visible from US Grant Place
3. Requires new or relocated scoreboard for upper field so that it accommodates both baseball and softball

Low pole lights, poor cut-off angles:

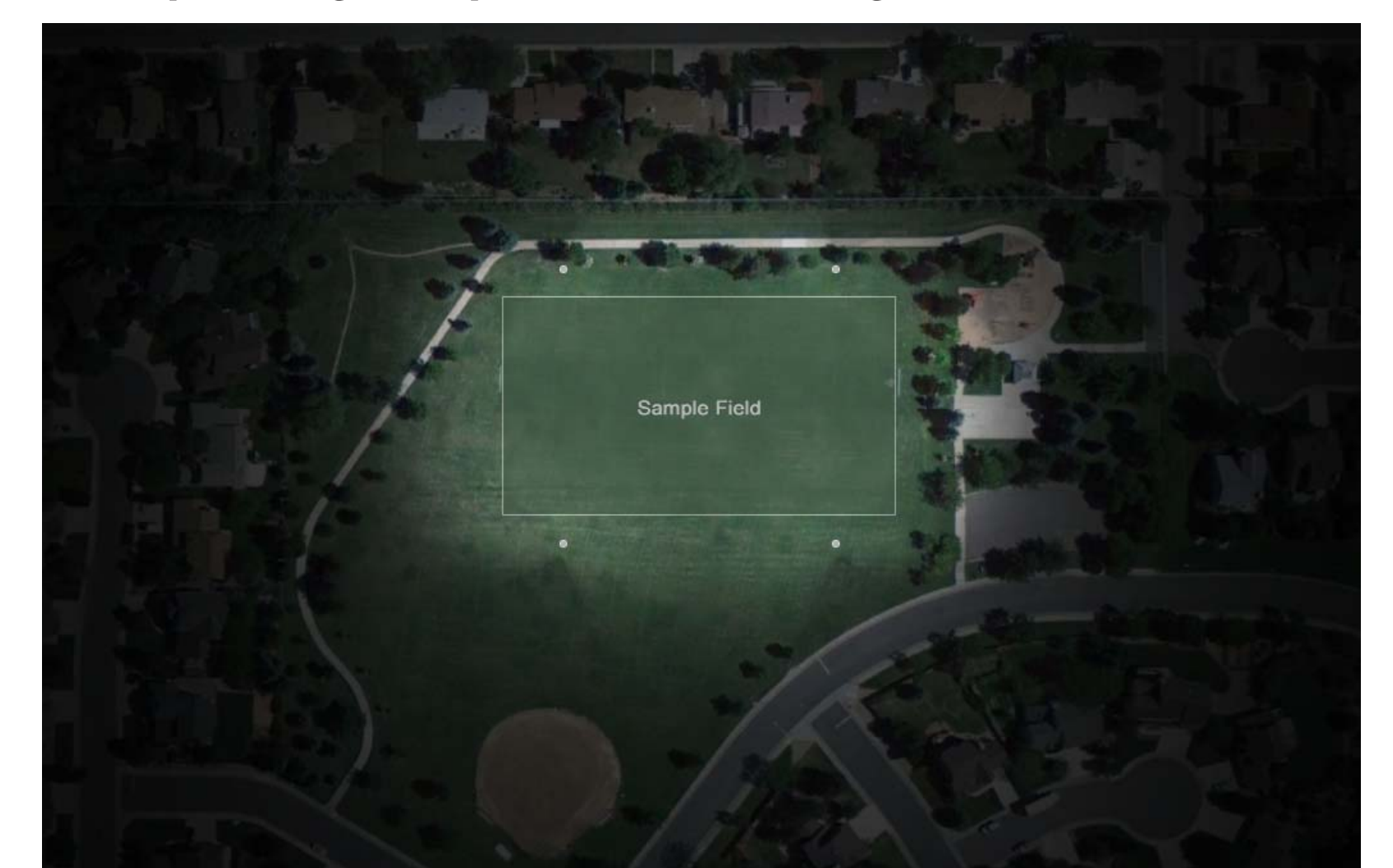

Tall pole lights, sharper cut-off angles:

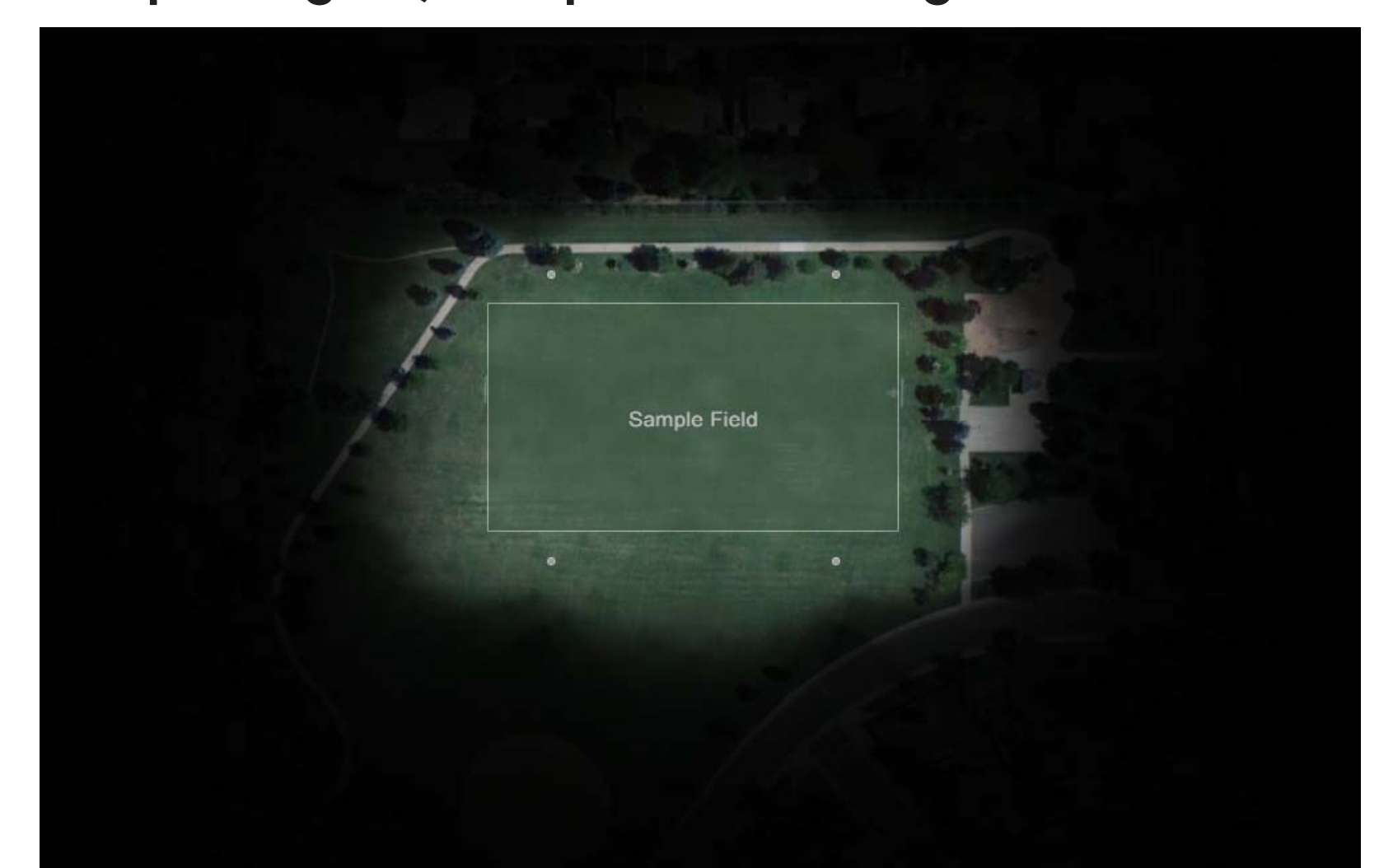





ACCESS AND SECURITY

OPTION A - Softball in the Bowl

ACCESS AND SECURITY

LEGEND

-  EXISTING FENCE
-  PROPOSED BACKSTOP (semi-permanent)
-  TEMPORARY BACKSTOP
-  PROPOSED FENCE
-  PROPOSED GATE*

*Proposed gates to remain open unless closure is required for security during large events

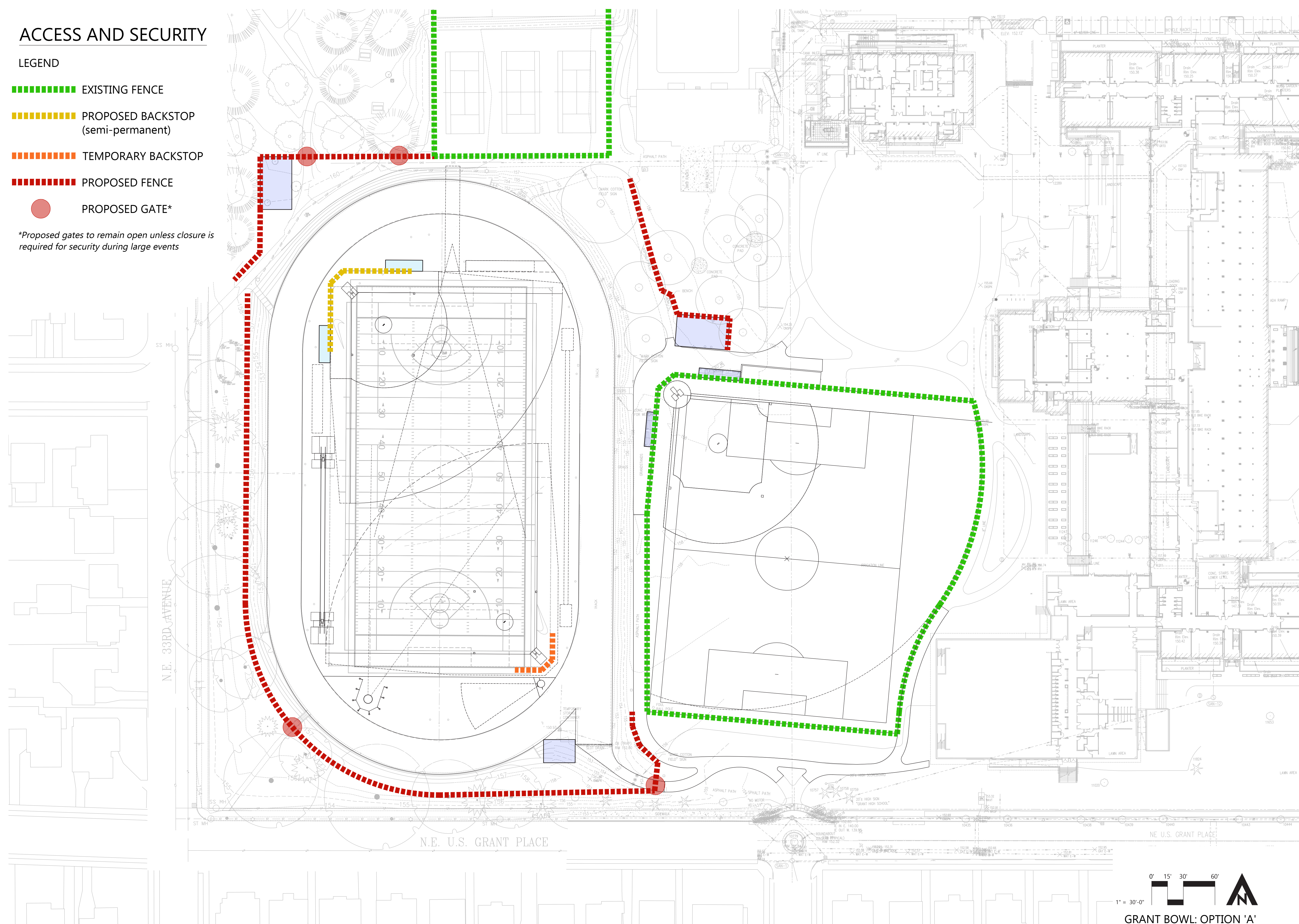

PROS

1. All gates remain open for park use except during ticketed events
2. Wider security perimeter allows movement from one side of the bowl to the other without leaving the ticketed zone
3. Maintains current emergency/maintenance vehicle access to the Bowl

CONS

1. Requires four ticket control points
2. More extensive fencing has bigger visual impact to the park

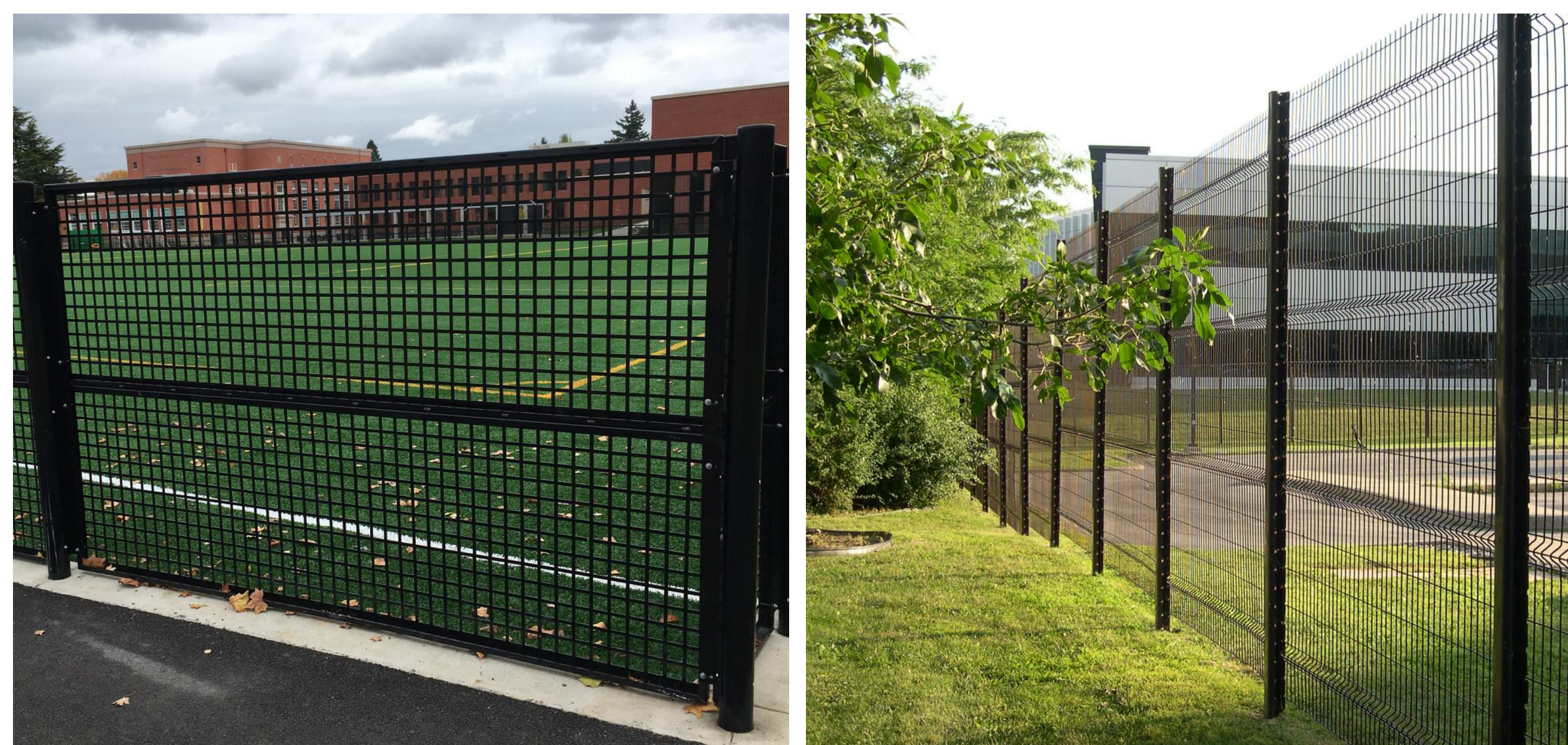





ACCESS AND SECURITY

OPTION B - Softball at the Upper Field

ACCESS AND SECURITY

LEGEND

-  EXISTING FENCE
-  PROPOSED BACKSTOP (permanent)
-  TEMPORARY BACKSTOP
-  PROPOSED FENCE
-  PROPOSED GATE*

*Proposed gates to remain open unless closure is required for security during large events

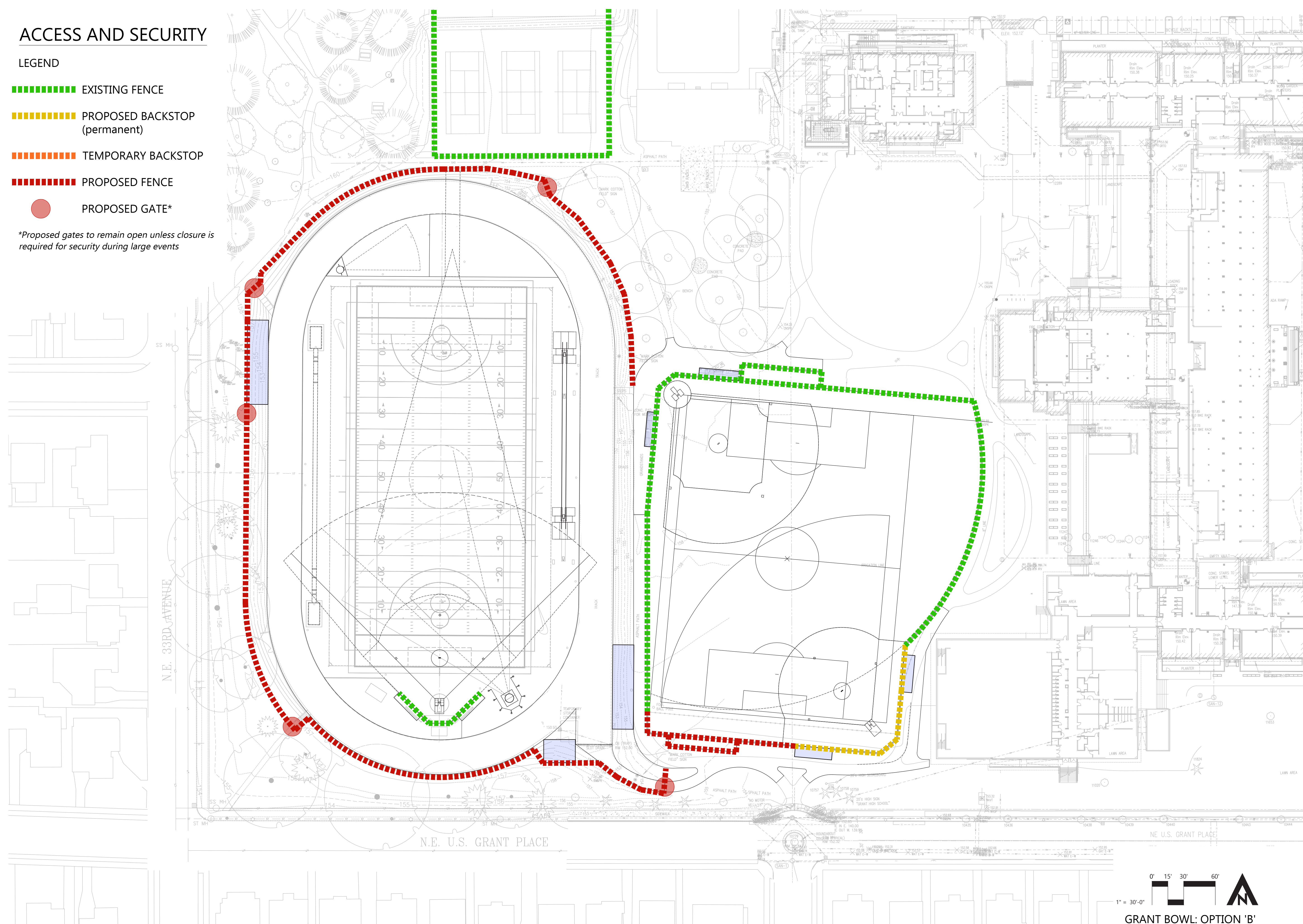

PROS

1. All gates remain open for park use except during ticketed events
2. Requires the minimum extent of fencing to establish secure perimeter
3. Fencing remains close to the bowl to minimize impact to the park
4. Maintains current emergency/maintenance vehicle access to the Bowl
5. Only requires three ticket control points

CONS

1. Movement from one side of the bowl to the other without leaving the ticketed zone is not accessible and requires use of the track

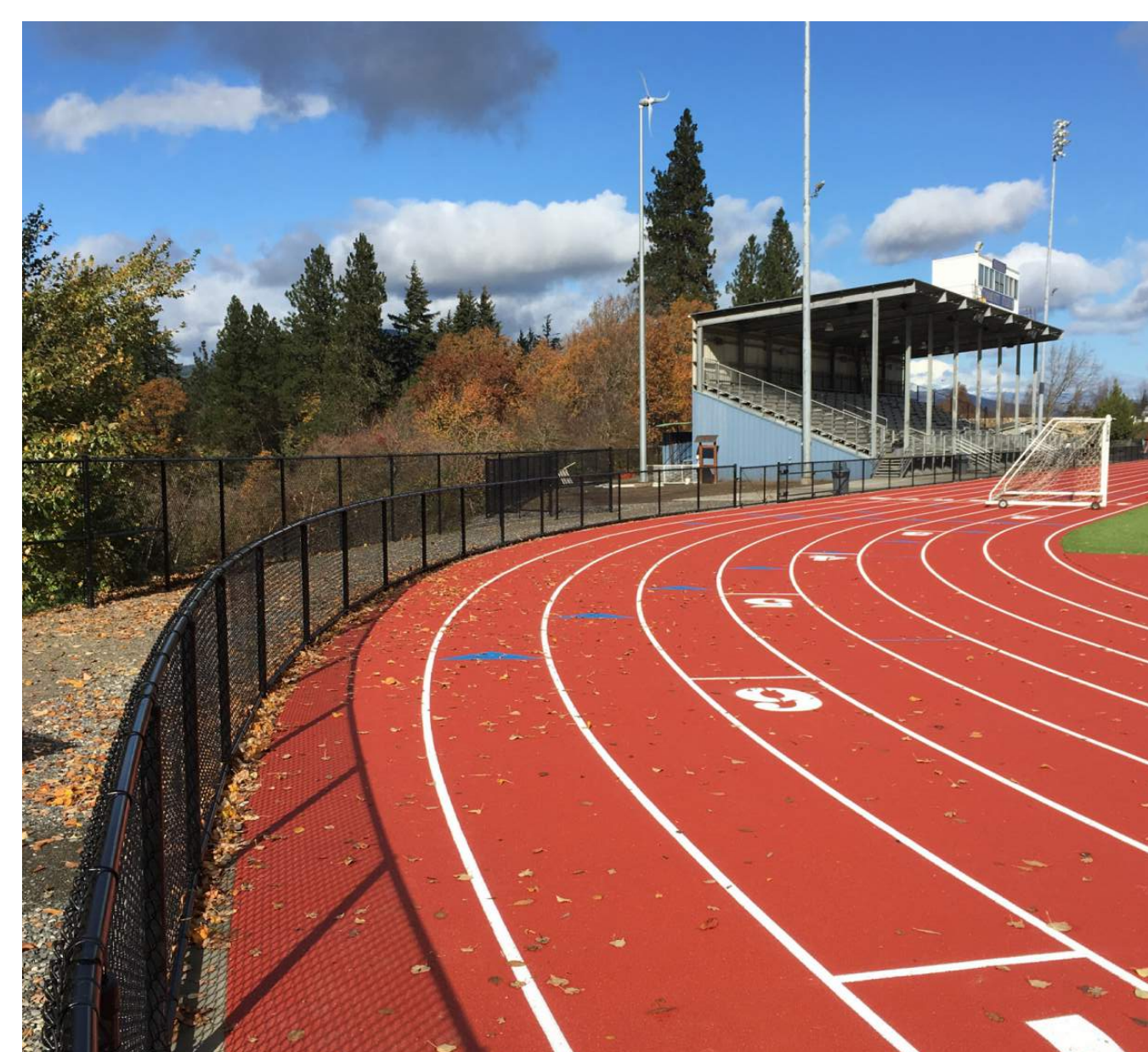

SUPPORT BUILDINGS

OPTION A - Integrated Structures

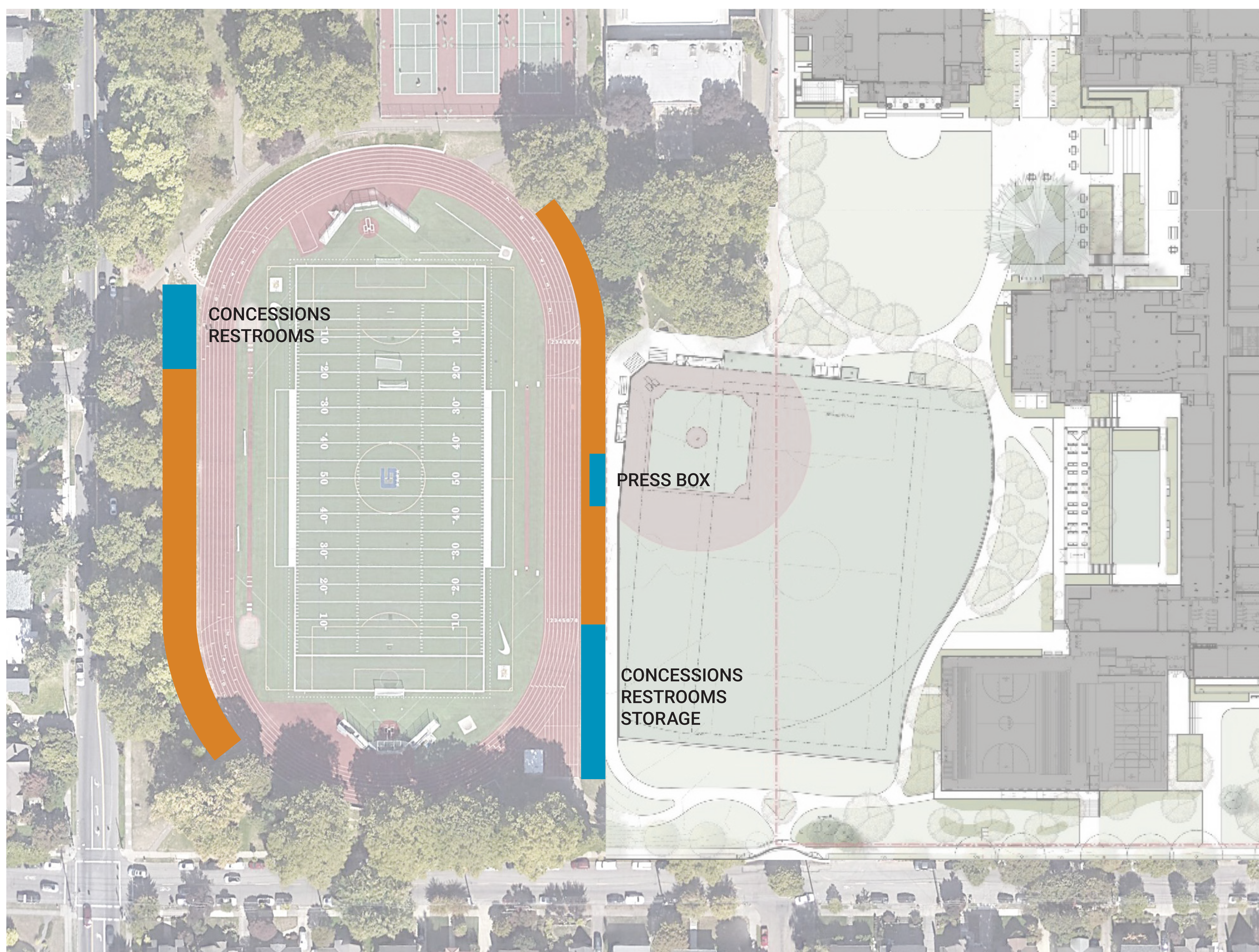

Pros

1. Minimizes building footprint in the park
2. Tree preservation
3. Convenience and accessibility of amenities from Bowl
4. Potential for additional seating capacity in the curves
5. Less visual impact of building masses
6. Potential for seating terraces to merge into the slope
7. Upper field served by convenient amenities

Cons

1. Additional seating areas have poorer sightlines to center of bowl
2. Two amenity buildings have larger footprint

SUPPORT BUILDINGS

OPTION B - Freestanding Structures

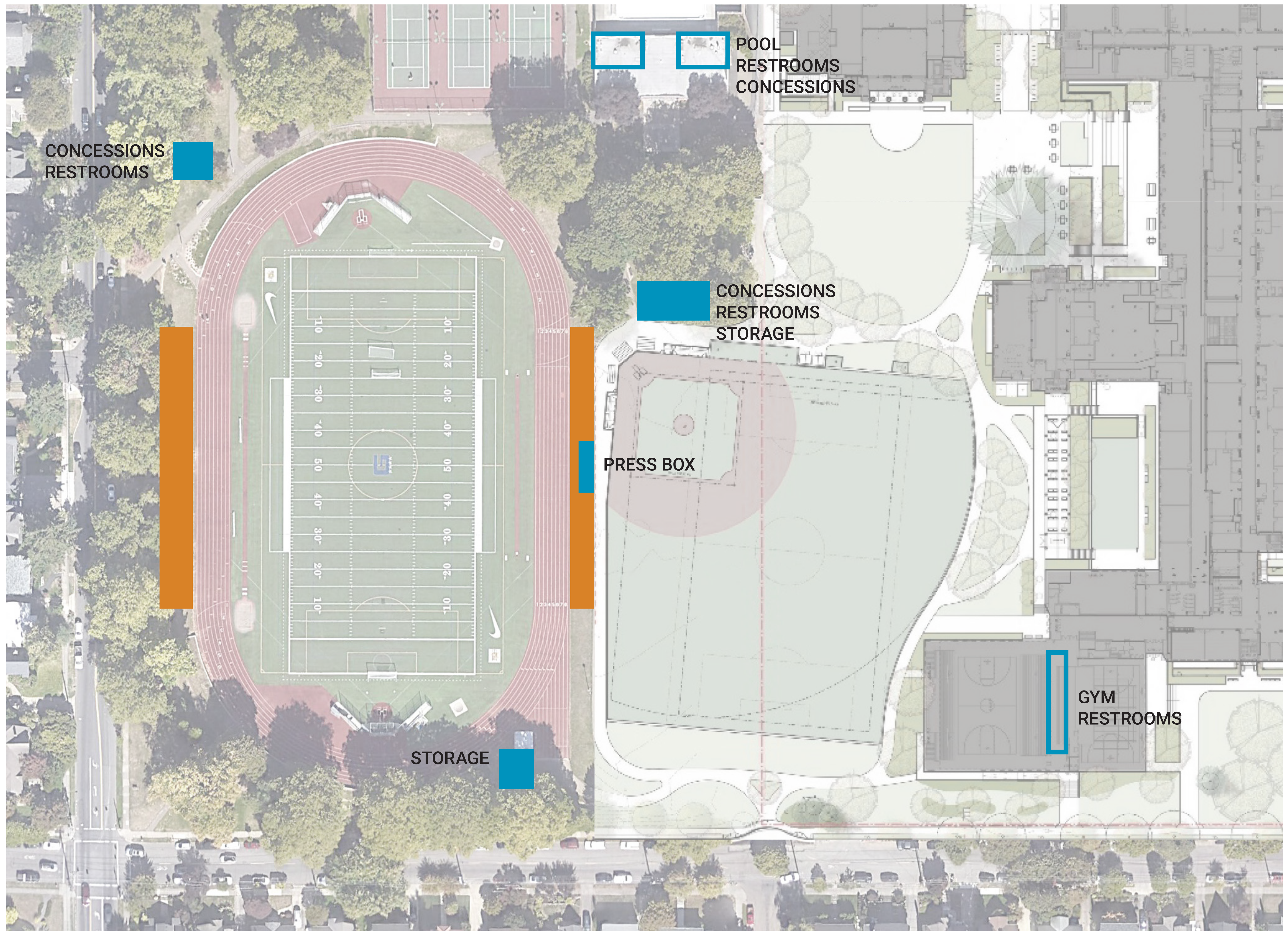

Pros

1. Minimizes building mass at the Bowl
2. Conveniently serves upper field
3. No impact to seat count
4. Phaseable construction

Cons

1. Visual impact to the park
2. Requires removal of tree(s)
3. Distance from Bowl to amenities
4. Requires more extensive fencing
5. Lacks clear primary entries to stadium

Question

1. Could pool building and/or gymnasium restrooms be used for maximum capacity events?

GRANDSTAND SEATING

EAST TERRACES



CONCRETE SEATING TERRACES

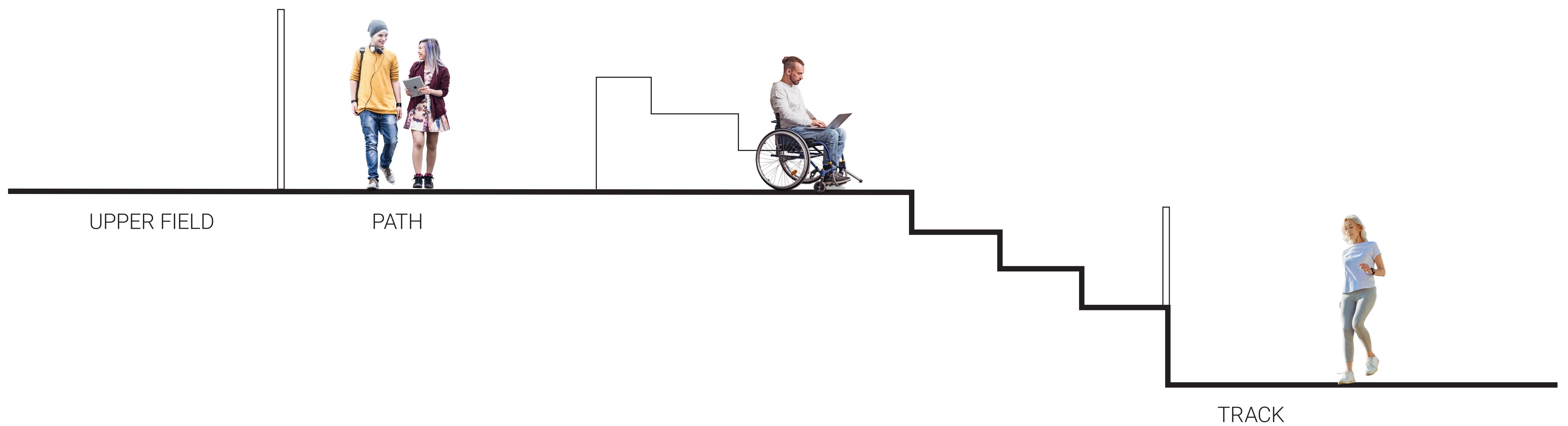
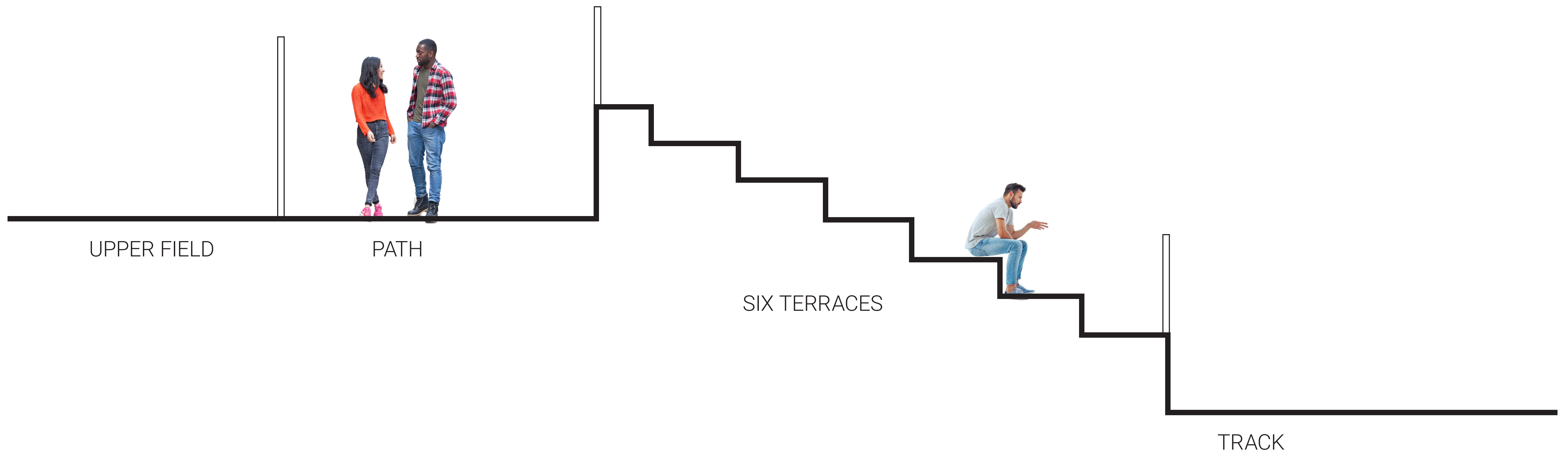

EXISTING CONDITION

GRANDSTAND SEATING

WEST TERRACES

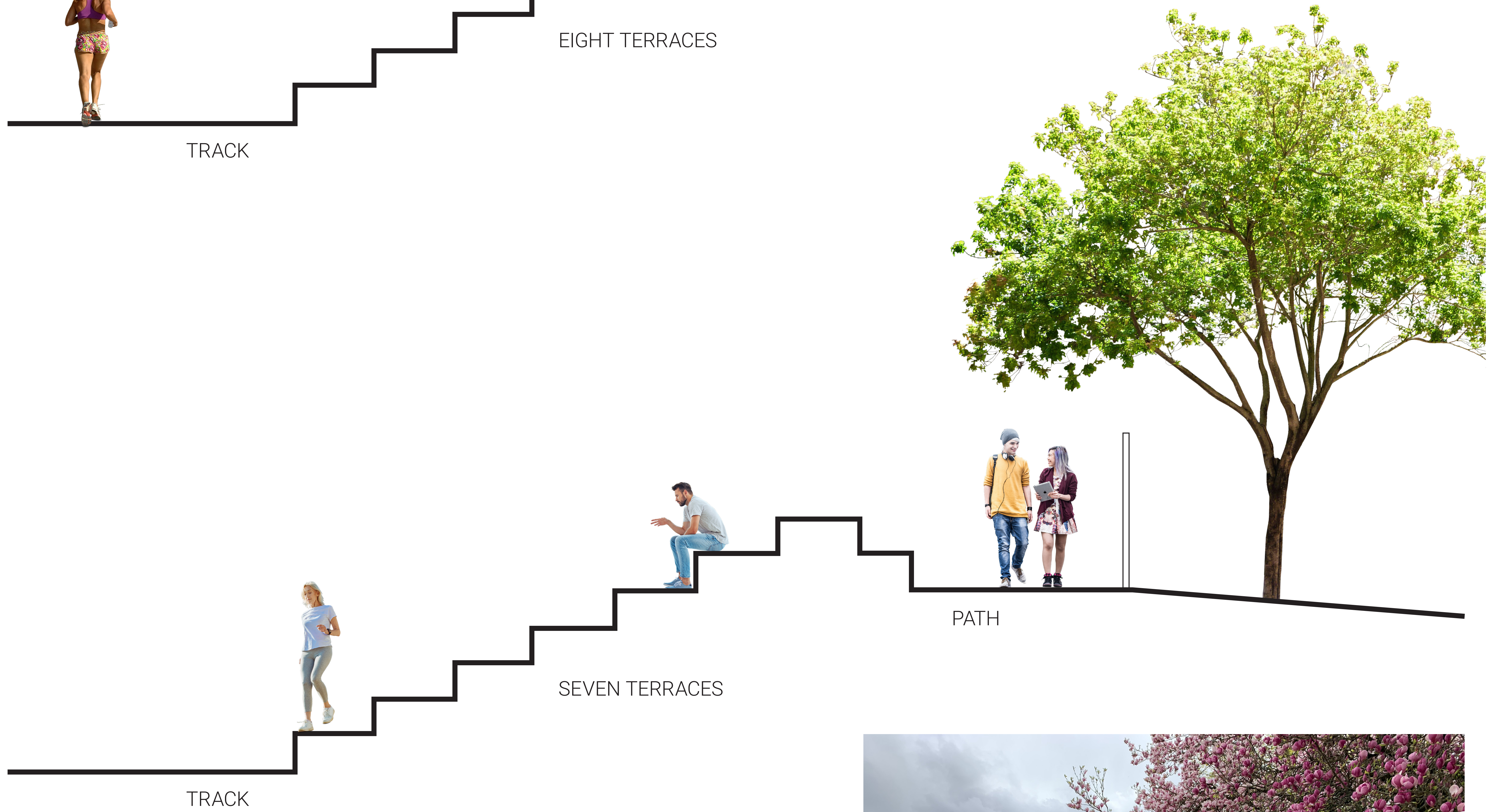
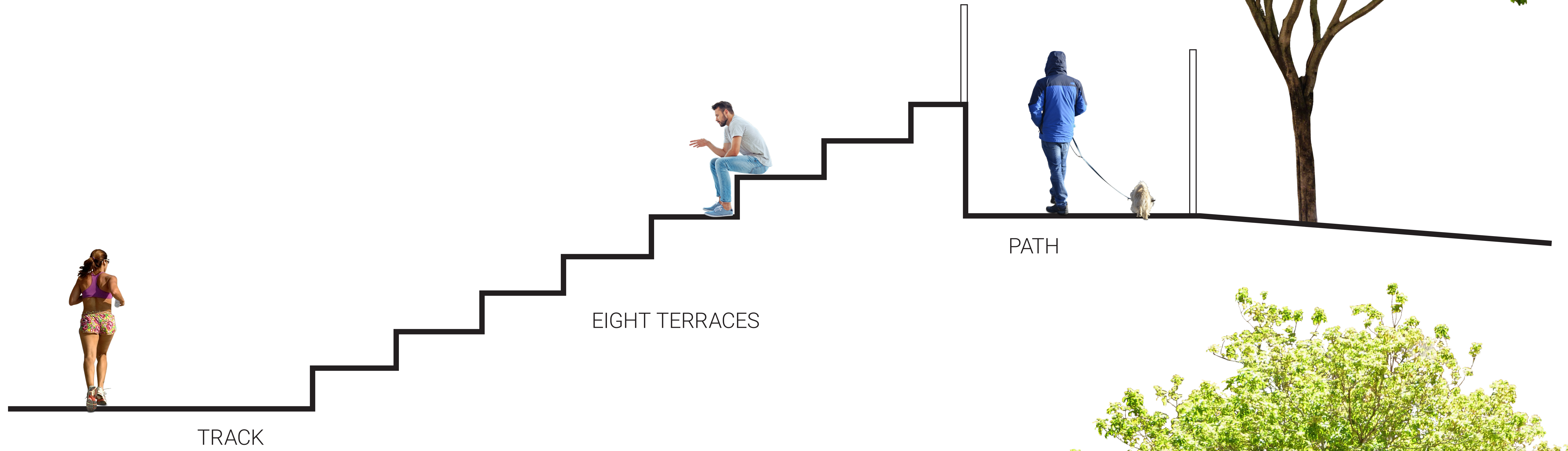

GRANDSTAND SEATING



WEST TERRACES



EAST TERRACES

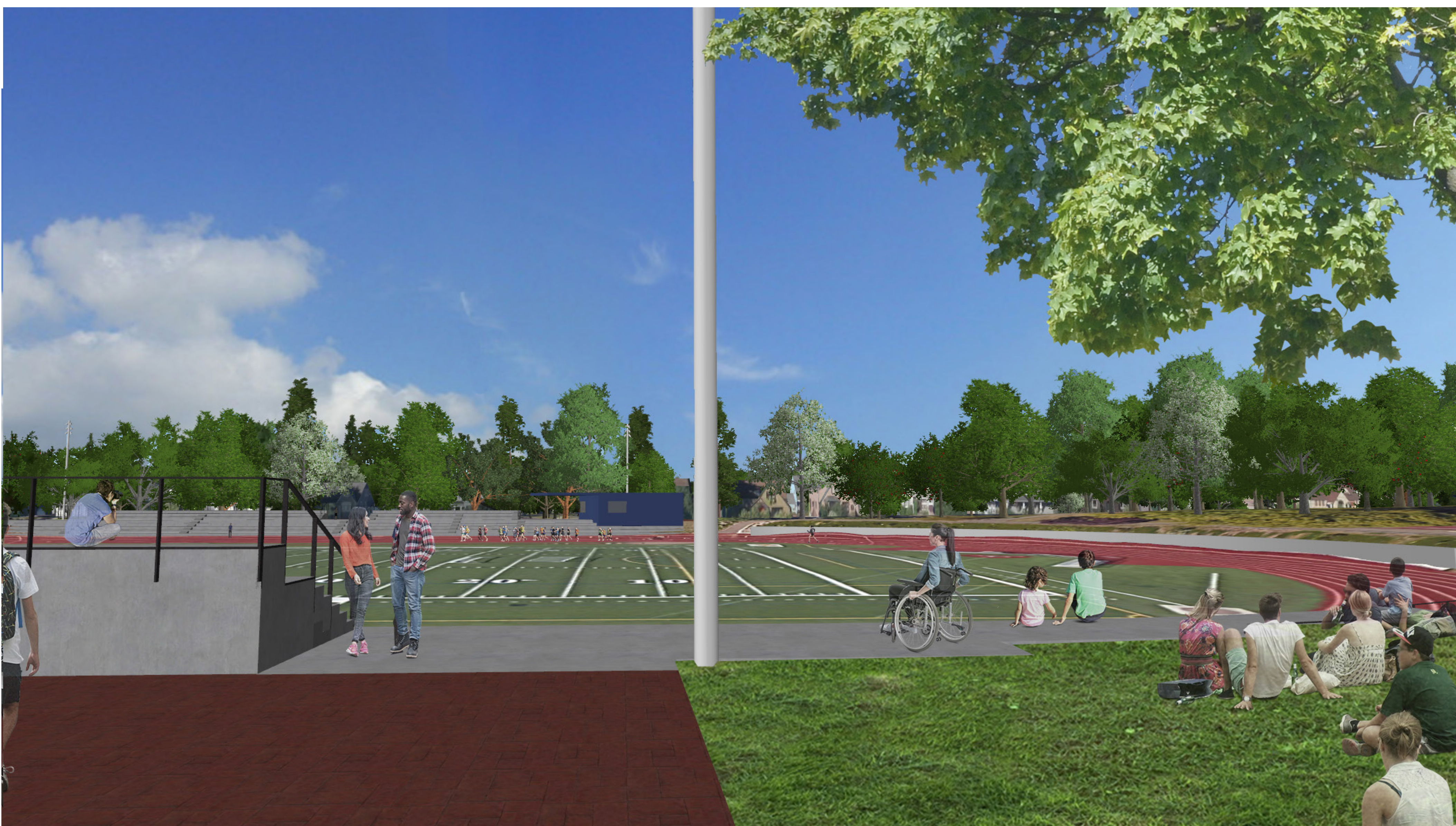

LOOKING WEST

GRANDSTAND SEATING



VIEW FROM NE THOMPSON



VIEW FROM NE 33RD



LOOKING EAST